

LEDSPOTS ACTIVE PLUS & EVOLVE



NEW MODULAR LED ENGINES FOR MULTIPLE OPTICS CONFIGURATIONS

One of the main characteristics of this LED engines is their flexibility. The modularity of these LED engines allows you to combine different lenses and reflectors in order to get the result you expect.

Moreover, with its easy to fit technology you connect optics or reflectors in a blink of an eye – just click it in.

Typical applications for LEDSpots

Integration in luminaires

- Residential lighting
- Retail lighting
- Hospitality lighting



LEDSpot Engines for Active PLUS and Evolve

LEDSpot engine equipped with LED module, holder, thermal pad, heat sink and leads but without reflector or optics

Technical notes

For reflectors PLUS and optics Evolve

Optics fixation: click-in

Heat sink material: aluminium

Lumen maintenance S123/S124:

L90/B10; 50,000 hrs. at 80 °C (350 mA)

Max. operating temperature at t_p point: 110 °C at 350 mA

Lumen maintenance 7.2/9.2:

L90/B20; 50,000 hrs. at 80 °C (500 mA)

Max. operating temperature at t_p point: 100 °C at 500 mA

Temperature depends on installation situation and has to be checked by the luminaire manufacturer.

Colour accuracy initially: 2 SDCM (S123/S124)

3 SDCM (7.2/9.2)

Leads: Cu tinned, stranded conductors 0.5 mm²,

length: 200 mm, stripped lead ends (with plug on request)

With integrated cord grip

Type	Weight g	Packaging unit (pcs.)
Engine S123/S124 300 mA	100	45
Engine S123/S124 350 mA	120	28
Engine 9.2	100	45
Engine 7.2	80	90
Engine Halo	140	28



LEDSpot Engine S123 & S124

A – Engine S123/S124

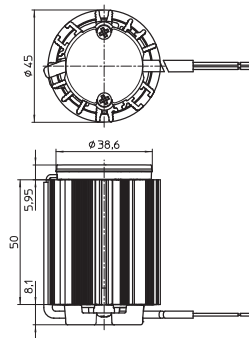

LEDSpot Engine 7.2 & 9.2

B – Engine S123/S124

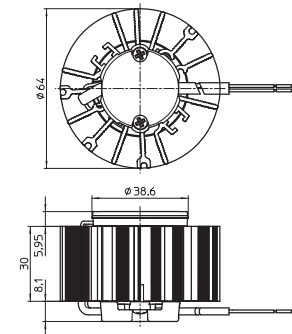

C – Engine 9.2

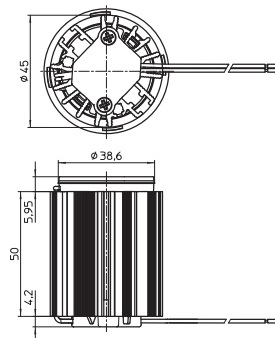

D – Engine 7.2

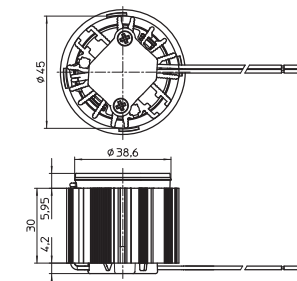

E – Engine Halo

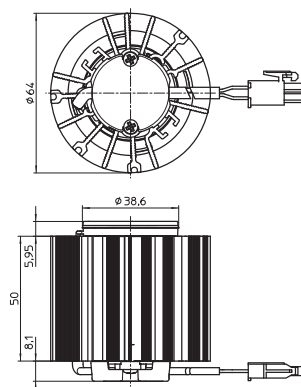

The values contained in this data sheet can change due to technical innovations. Any such changes will be made without separate notification.

LEDSpot Engines Active PLUS and Evolve

Electrical characteristics

Type	14 mA		250 mA		300 mA		350 mA		500 mA	
	P _{el} (W)	V _f (V)	P _{el} (W)	V _f (V)	P _{el} (W)	V _f (V)	P _{el} (W)	V _f (V)	P _{el} (W)	V _f (V)
Engine S123	–	–	8.7	34.8	10.6	35.3	12.5	35.8	–	–
Engine S124	–	–	8.4	33.7	10.3	34.2	12.1	34.7	–	–
Engine 9.2	–	–	4.1	16.5	5.0	16.7	6.1	17.3	8.9	17.85
Engine 7.2	–	–	4.1	16.5	5.0	16.7	6.1	17.3	–	–
Engine Halo	0.4	26.9	–	–	–	–	11.3	33.8	–	–

Voltage and power tolerance: ± 10%

Optical characteristics

at t_p 70 °C

Type	Ref. No.	Colour	Correlated colour temperature K	Typ. luminous flux and efficiency at				CRI R _a	Energy efficiency at max. current
				250 mA		300 mA			
				lm	lm/W	lm	lm/W		

LEDSpot Engine S123/S124 up to 300 mA – Drawing A

Engine S123 300mA	567043	warm white	2700	890	102	1035	98	95	A+
Engine S124 300mA	567044	warm white	3000	1000	119	1180	115	95	A++
Engine S124 300mA	567045	neutral white	4000	1105	132	1300	126	95	A++

Production tolerance of luminous flux and efficiency: ± 10%

Type	Ref. No.	Colour	Correlated colour temperature K	Typ. luminous flux and efficiency at						CRI R _a	Energy efficiency at max. current
				250 mA		300 mA		350 mA			
				lm	lm/W	lm	lm/W	lm	lm/W		

LEDSpot Engine S123/S124 up to 350 mA – Drawing B

Engine S123 350mA	567051	warm white	2700	890	102	1035	98	1175	94	95	A+
Engine S124 350mA	567052	warm white	3000	1000	119	1180	115	1355	112	95	A+
Engine S124 350mA	567053	neutral white	4000	1105	132	1300	126	1500	124	95	A+

Production tolerance of luminous flux and efficiency: ± 10%

Type	Ref. No.	Colour	Correlated colour temperature K	Typ. luminous flux and efficiency at				CRI R _a	Energy efficiency at max. current
				350 mA		500 mA			
				lm	lm/W	lm	lm/W		

LEDSpot Engine 9.2 – Drawing C

Engine 9.2 500mA	567038	warm white	2700	775	127	1070	120	80	A++
Engine 9.2 500mA	567040	warm white	3000	805	132	1120	126	80	A++
Engine 9.2 500mA	567041	neutral white	4000	835	137	1160	130	80	A++

LEDSpot Engine 7.2 – Drawing D

Engine 7.2 350mA	567032	warm white	2700	775	127	–	–	80	A++
Engine 7.2 350mA	567033	warm white	3000	805	132	–	–	80	A++
Engine 7.2 350mA	567034	neutral white	4000	835	137	–	–	80	A++

Production tolerance of luminous flux and efficiency: ± 10%

Type	Ref. No.	Colour	Correlated colour temperature K	Typ. luminous flux and efficiency at				CRI R _a	Energy efficiency at max. current
				14 mA		350 mA			
				lm	lm/W	lm	lm/W		

LEDSpot Engine Halo – Drawing E

Engine Halo 350mA	566659	warm white	3000 → 1800	28	70	1030	91	95	A+
-------------------	---------------	------------	-------------	----	----	------	----	----	----

Production tolerance of luminous flux and efficiency: ± 10%

The values contained in this data sheet can change due to technical innovations. Any such changes will be made without separate notification.

Reflectors PLUS and Optics Evolve for LEDSpot Engines

Technical notes

For click-in fixation on holders Easy

Diameter: 50 mm

Material: PC

Operating temperature: -40 to 110 °C

Storage temperature: -40 to 60 °C

Packaging units: 30 Pcs.



Reflectors - Active PLUS



Optics - Evolve

Reflectors - Active PLUS

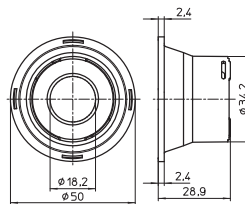

Optics - Evolve

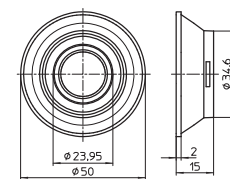

Reflectors - Active PLUS

Ref. No.	For LED modules	Beam angle (°)	Cover	Optical efficiency (%)	Weight g
603685	S124, S123, 9.2, 7.2	16	Clear	87	10
603687	S124, S123, 9.2, 7.2	24	Clear	86	10
603689	S124, S123, 9.2, 7.2	40	Clear	85	10
603686	S124, S123, 9.2, 7.2, Halo	19	Frost	86	10
603688	S124, S123, 9.2, 7.2, Halo	26	Frost	85	10
603690	S124, S123, 9.2, 7.2, Halo	42	Frost	84	10

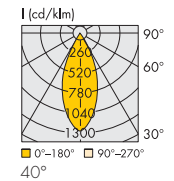
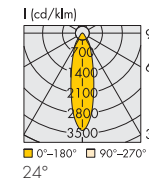
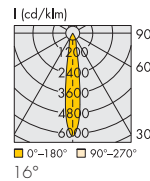

Optics Evolve

Ref. No.	For LED modules	Beam angle (°)	Cover	Optical efficiency (%)	Weight g
603672	S124, S123, 9.2, 7.2, Halo*	14	—	87	15
603673	S124, S123, 9.2, 7.2, Halo*	25	—	86	15
603674	S124, S123, 9.2, 7.2, Halo*	34	—	89	15

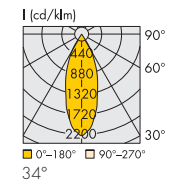
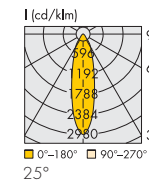
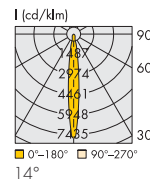

* In addition with mixing chamber

*Mixing Chamber for Halo

Material: PC

Fixation: click-in

Ref. No.: 604024

Mixing Chamber

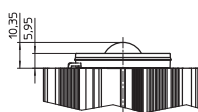

Flange Evolve

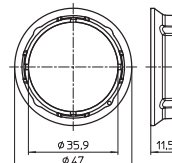

Flange Evolve

To reduce light leakage (optional)

Material: PBT, black

Ref. No.: 603681

The values contained in this data sheet can change due to technical innovations. Any such changes will be made without separate notification.

Active LUGA S124/S123 PLUS

Technical notes

Reflector: Ø 50 mm, heat sink material: aluminium
 Lumen maintenance: L90/B10; 50,000 hrs. 80 °C (350 mA)
 Max. operating temperature at t_p point: 110 °C at 350 mA
 Temperature depends on installation situation and has to be checked by the luminaire manufacturer.
 Colour accuracy initially: 2 SDCM
 Plastic clear cover to protect reflector (opaque cover on request)
 Leads: Cu tinned, stranded conductors 0.5 mm²,
 length: 200 mm, stripped lead ends (with plug on request)
 With integrated cord grip
 Weight: 145/150 g (heat sink Ø 45 mm / Ø 64 mm)
 Packaging unit: 45/24 pcs. (heat sink Ø 45 mm / Ø 64 mm)

Electrical characteristics

Type	250 mA		300 mA		350 mA	
	P _{el} [W]	V _f [V]	P _{el} [W]	V _f [V]	P _{el} [W]	V _f [V]
S123	8.7	34.8	10.6	35.3	12.5	35.8
S124	8.4	33.7	10.3	34.2	12.1	34.7

Voltage and power tolerance: ± 10%

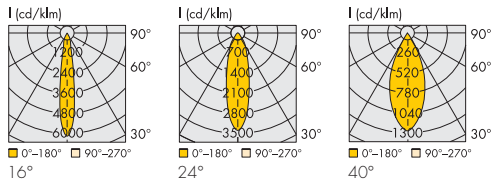

A - up to 300 mA



B - up to 350 mA

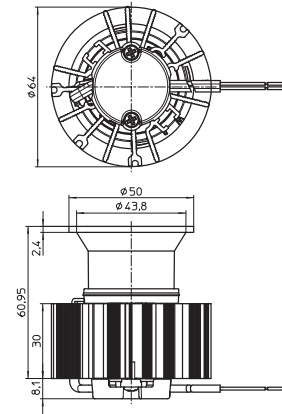
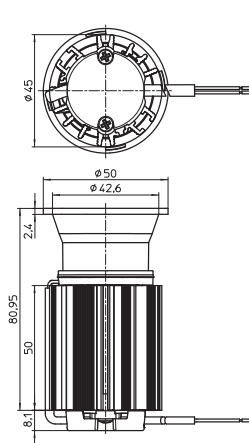

Type	Ref. No.	Colour	Correlated colour temp. K	Typ. luminous flux and efficiency at						Light intensity at max. current Candela	Beam angle °	CRI R _a	Energy efficiency at max. current
				250 mA		300 mA		350 mA					
				lm	lm/W	lm	lm/W	lm	lm/W				

Warm white – 2700 K – Drawing A

Active S123 PLUS 27K	567163	warm white	2700	785	90	915	86	—	—	5530	16	95	A+
Active S123 PLUS 27K	567164	warm white	2700	775	89	905	87	—	—	3130	24	95	A+
Active S123 PLUS 27K	567165	warm white	2700	765	88	895	87	—	—	1130	40	95	A+

Warm white – 3000 K – Drawing A

Active S124 PLUS 30K	567166	warm white	3000	885	105	1045	100	—	—	6220	16	95	A+
Active S124 PLUS 30K	567167	warm white	3000	875	104	1030	102	—	—	3530	24	95	A+
Active S124 PLUS 30K	567168	warm white	3000	865	103	1020	102	—	—	1260	40	95	A+

Neutral white – 4000 K – Drawing A

Active S124 PLUS 40K	567169	neutral white	4000	975	116	1150	112	—	—	6800	16	95	A+
Active S124 PLUS 40K	567170	neutral white	4000	965	115	1135	112	—	—	3850	24	95	A+
Active S124 PLUS 40K	567171	neutral white	4000	955	114	1120	108	—	—	1400	40	95	A+

Warm white – 2700 K – Drawing B

Active S123 PLUS 27K	567198	warm white	2700	785	90	915	86	1035	83	6220	16	95	A+
Active S123 PLUS 27K	567199	warm white	2700	775	89	905	87	1025	82	3520	24	95	A+
Active S123 PLUS 27K	567200	warm white	2700	765	88	895	87	1010	81	1290	40	95	A+

Warm white – 3000 K – Drawing B

Active S124 PLUS 30K	567201	warm white	3000	885	105	1045	100	1200	99	7100	16	95	A+
Active S124 PLUS 30K	567202	warm white	3000	875	104	1030	102	1185	98	4030	24	95	A+
Active S124 PLUS 30K	567203	warm white	3000	865	103	1020	102	1170	97	1460	40	95	A+

Neutral white – 4000 K – Drawing B

Active S124 PLUS 40K	567204	neutral white	4000	975	116	1150	112	1325	110	7740	16	95	A+
Active S124 PLUS 40K	567205	neutral white	4000	965	115	1135	112	1305	108	4390	24	95	A+
Active S124 PLUS 40K	567206	neutral white	4000	955	114	1120	108	1295	107	1590	40	95	A+

Production tolerance of luminous flux and efficiency: ± 10%

The values contained in this data sheet can change due to technical innovations. Any such changes will be made without separate notification.

Active 9.2 & 7.2 PLUS

Technical notes

Reflector: Ø 50 mm, heat sink material: aluminium
 Lumen maintenance: L90/B20; 50,000 hrs. 80 °C (500 mA)
 Max. operating temperature at t_p point: 100 °C at 500 mA
 Temperature depends on installation situation and has to be checked by the luminaire manufacturer.
 Colour accuracy initially: 3 SDCM
 Plastic clear cover to protect reflector (opaque cover on request)
 Leads: Cu tinned, stranded conductors 0.5 mm²,
 length: 200 mm, stripped lead ends (with plug on request)
 With integrated cord grip
 Weight: 145/95 g (ActiveLine 9.2/7.2)
 Packaging unit: 45 pcs.

Electrical characteristics

Type	350 mA		500 mA	
	P _{el} [W]	V _f [V]	P _{el} [W]	V _f [V]
9.2	6.1	17.3	8.9	17.85
7.2	6.1	17.3	—	—

Voltage and power tolerance: ± 10%

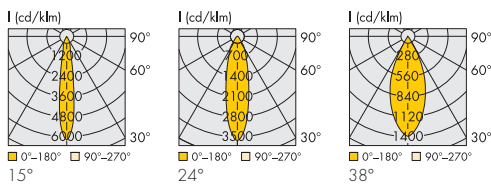

Active 9.2 PLUS

A – Active 9.2 PLUS



Active 7.2 PLUS

B – Active 7.2 PLUS

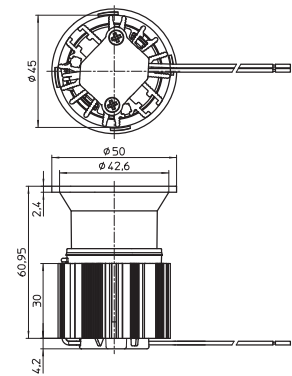
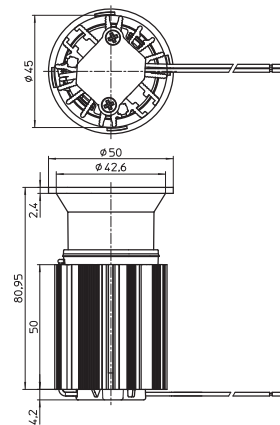

Type	Ref. No.	Colour	Correlated colour temp. K	Typ. luminous flux and efficiency at				Light intensity at max. current Candela	CRI R _a	Beam angle °	Energy efficiency at max. current
				350 mA lm	350 mA lm/W	500 mA lm	500 mA lm/W				
Warm white – 2700 K – Drawing A											
Active 9.2 PLUS 27K	567155	warm white	2700	680	111	950	107	5800	80	15	A+
Active 9.2 PLUS 27K	567156	warm white	2700	675	111	935	105	3410	80	24	A+
Active 9.2 PLUS 27K	567157	warm white	2700	665	109	925	104	1300	80	38	A+
Warm white – 3000 K – Drawing A											
Active 9.2 PLUS 30K	567158	warm white	3000	710	116	985	111	6050	80	15	A++
Active 9.2 PLUS 30K	567159	warm white	3000	705	116	975	110	3550	80	24	A++
Active 9.2 PLUS 30K	566860	warm white	3000	695	114	965	108	1350	80	38	A++
Neutral white – 4000 K – Drawing A											
Active 9.2 PLUS 40K	567160	neutral white	4000	740	121	1025	115	6300	80	15	A++
Active 9.2 PLUS 40K	567161	neutral white	4000	730	120	1015	114	3700	80	24	A++
Active 9.2 PLUS 40K	567162	neutral white	4000	725	119	1005	113	1400	80	38	A++
Warm white – 2700 K – Drawing B											
Active 7.2 PLUS 27K	567147	warm white	2700	680	111	—	—	4270	80	15	A++
Active 7.2 PLUS 27K	567148	warm white	2700	675	111	—	—	2495	80	24	A++
Active 7.2 PLUS 27K	567149	warm white	2700	665	109	—	—	960	80	38	A++
Warm white – 3000 K – Drawing B											
Active 7.2 PLUS 30K	567150	warm white	3000	710	116	—	—	4450	80	15	A++
Active 7.2 PLUS 30K	567151	warm white	3000	705	116	—	—	2600	80	24	A++
Active 7.2 PLUS 30K	566858	warm white	3000	695	114	—	—	1000	80	38	A++
Neutral white – 4000 K – Drawing B											
Active 7.2 PLUS 40K	567152	neutral white	4000	740	121	—	—	4620	80	15	A++
Active 7.2 PLUS 40K	567153	neutral white	4000	730	120	—	—	2700	80	24	A++
Active 7.2 PLUS 40K	567154	neutral white	4000	725	119	—	—	1040	80	38	A++

Production tolerance of luminous flux and efficiency: ± 10%

The values contained in this data sheet can change due to technical innovations. Any such changes will be made without separate notification.

Active Halo PLUS

Dim to warm

Technical notes

Reflector: Ø 50 mm
 Heat sink material: aluminium
 Lumen maintenance: L90/B20; 50,000 hrs. 80 °C (350 mA)
 Max. operating temperature at t_p point: 100 °C at 350 mA
 Temperature depends on installation situation and has to be checked by the luminaire manufacturer.
 Colour accuracy initially: 3 SDCM
 Plastic frost cover to protect reflector
 Leads: Cu tinned, stranded conductors 0.5 mm², length: 200 mm, with plug
 With integrated cord grip
 Weight: 150 g
 Packaging unit: 24 pcs.

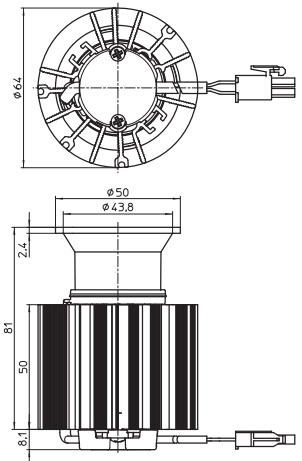

Electrical characteristics

Type	14 mA		350 mA	
	P _{el} [W]	V _f [V]	P _{el} [W]	V _f [V]
Active HALO	0.4	26.9	11.3	33.8

Voltage and power tolerance: ± 10%

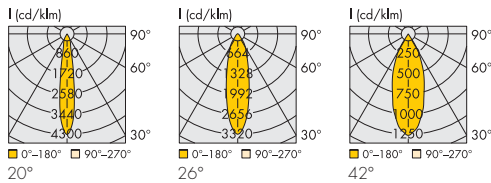

Type	Ref. No.	Colour	Correlated colour temp. K	Typ. luminous flux and colour temperature at				Light intensity at max. current Candela	CRI R _a	Beam angle °	Energy efficiency at max. current
				14 mA		350 mA					
				lm	K	lm	K				
ActiveLine HALO – Warm white											
Active HALO PLUS	566834	warm white	3000 → 1800	24	1800	900	3000	3850	95	20	A+
Active HALO PLUS	566835	warm white	3000 → 1800	24	1800	890	3000	2950	95	26	A+
Active HALO PLUS	566837	warm white	3000 → 1800	24	1800	880	3000	1100	95	42	A+

Production tolerance of luminous flux: ± 10%

The values contained in this data sheet can change due to technical innovations. Any such changes will be made without separate notification.

Evolve 124/123

Technical notes

Lens: Ø 50 mm, heat sink material: aluminium
 Lumen maintenance: L90/B10; 50,000 hrs. 80 °C (350 mA)
 Max. operating temperature at t_p point: 110 °C at 350 mA
 Temperature depends on installation situation and has to be checked by the luminaire manufacturer.
 Colour accuracy initially: 2 SDCM
 Plastic clear cover to protect reflector (opaque cover on request)
 Leads: Cu tinned, stranded conductors 0.5 mm²,
 length: 200 mm, stripped lead ends (with plug on request)
 With integrated cord grip
 Weight: 145/150 g (heat sink Ø 45 mm / Ø 64 mm)
 Packaging unit: 45/24 pcs. (heat sink Ø 45 mm / Ø 64 mm)

Electrical characteristics

Type	250 mA		300 mA		350 mA	
	P_{el} (W)	V_f (V)	P_{el} (W)	V_f (V)	P_{el} (W)	V_f (V)
S123	8.7	34.8	10.6	35.3	12.5	35.8
S124	8.4	33.7	10.3	34.2	12.1	34.7

Voltage and power tolerance: ± 10%

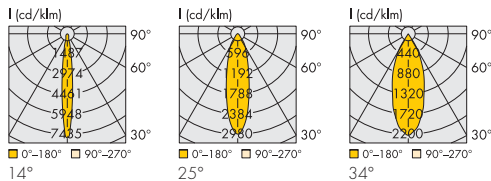

A – up to 300 mA



B – up to 350 mA

A – up to 300 mA

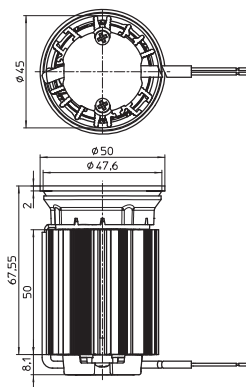

B – up to 350 mA

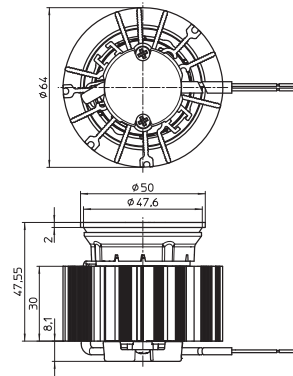

Type	Ref. No.	Colour	Correlated colour temp. K	Typ. luminous flux and efficiency at						Light intensity at max. current Candela	CRI R _a	Beam angle °	Energy efficiency at max. current
				250 mA lm	250 mA lm/W	300 mA lm	300 mA lm/W	350 mA lm	350 mA lm/W				
Warm white – 2700 K – Drawing A													
Evolve S123 27K	567101	warm white	2700	785	90	915	86	–	–	6810	95	14	A+
Evolve S123 27K	567102	warm white	2700	775	89	900	85	–	–	2700	95	25	A+
Evolve S123 27K	567103	warm white	2700	800	92	935	88	–	–	2050	95	34	A+
Warm white – 3000 K – Drawing A													
Evolve S124 30K	567104	warm white	3000	885	105	1045	101	–	–	7770	95	14	A+
Evolve S124 30K	567105	warm white	3000	875	104	1030	100	–	–	3070	95	25	A+
Evolve S124 30K	567106	warm white	3000	905	108	1070	104	–	–	2360	95	34	A+
Neutral white – 4000 K – Drawing A													
Evolve S124 40K	567107	neutral white	4000	975	116	1150	112	–	–	8400	95	14	A+
Evolve S124 40K	567108	neutral white	4000	965	115	1135	110	–	–	3340	95	25	A+
Evolve S124 40K	567109	neutral white	4000	1000	119	1175	114	–	–	2550	95	34	A+
Warm white – 2700 K – Drawing B													
Evolve S123 27K	567119	warm white	2700	785	90	915	86	1035	83	7650	95	14	A+
Evolve S123 27K	567120	warm white	2700	775	89	900	85	1025	82	3020	95	25	A+
Evolve S123 27K	567121	warm white	2700	800	92	935	88	1060	85	2320	95	34	A+
Warm white – 3000 K – Drawing B													
Evolve S124 30K	567122	warm white	3000	885	105	1045	101	1195	99	8810	95	14	A+
Evolve S124 30K	567123	warm white	3000	875	104	1030	100	1185	98	3480	95	25	A+
Evolve S124 30K	567124	warm white	3000	905	108	1070	104	1225	101	2680	95	34	A+
Neutral white – 4000 K – Drawing B													
Evolve S124 40K	567125	neutral white	4000	975	116	1150	112	1325	110	9600	95	15	A+
Evolve S124 40K	567126	neutral white	4000	965	115	1135	110	1310	108	3790	95	25	A+
Evolve S124 40K	567128	neutral white	4000	1000	119	1175	114	1355	112	2920	95	34	A+

Production tolerance of luminous flux and efficiency: ± 10%

The values contained in this data sheet can change due to technical innovations. Any such changes will be made without separate notification.

Evolve 9.2 & 7.2

Technical notes

Lens: Ø 50 mm, heat sink material: aluminium
 Lumen maintenance: L90/B20; 50,000 hrs. 80 °C (500 mA)
 Max. operating temperature at t_p point: 100 °C at 500 mA
 Temperature depends on installation situation and has to be checked by the luminaire manufacturer.
 Colour accuracy initially: 3 SDCM
 Plastic clear cover to protect reflector (opaque cover on request)
 Leads: Cu tinned, stranded conductors 0.5 mm²,
 length: 200 mm, stripped lead ends (with plug on request)
 With integrated cord grip
 Weight: 145/95 g (Evolve 9.2/7.2)
 Packaging unit: 45 pcs.

Electrical characteristics

Type	350 mA		500 mA	
	P_{el} [W]	V_f [V]	P_{el} [W]	V_f [V]
9.2	6.1	17.3	8.9	17.85
7.2	6.1	17.3	—	—

Voltage and power tolerance: ± 10%

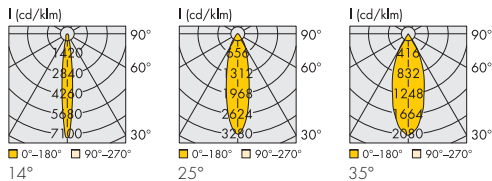

Evolve 9.2

A – Evolve 9.2

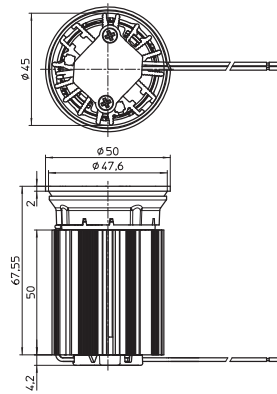

Evolve 7.2

B – Evolve 7.2

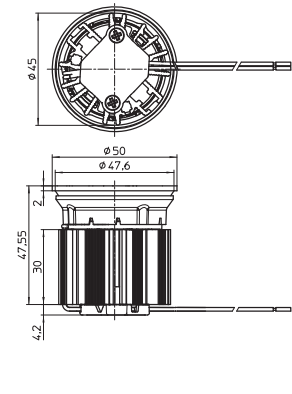

Type	Ref. No.	Colour	Correlated colour temp. K	Typ. luminous flux and efficiency at				Light intensity at max. current Candela	CRI R_a	Beam angle °	Energy efficiency at max. current
				350 mA lm	350 mA lm/W	500 mA lm	500 mA lm/W				
Warm white – 2700 K – Drawing A											
Evolve 9.2 27K	567138	warm white	2700	685	112	950	107	6810	80	14	A+
Evolve 9.2 27K	567139	warm white	2700	675	111	940	106	3070	80	25	A+
Evolve 9.2 27K	567140	warm white	2700	700	115	970	109	2020	80	35	A+
Warm white – 3000 K – Drawing A											
Evolve 9.2 30K	567141	warm white	3000	710	116	990	111	7100	80	14	A++
Evolve 9.2 30K	567142	warm white	3000	705	116	975	110	3200	80	25	A++
Evolve 9.2 30K	567143	warm white	3000	725	119	1010	114	2100	80	35	A++
Neutral white – 4000 K – Drawing A											
Evolve 9.2 27K	567144	neutral white	4000	740	121	1025	115	7390	80	14	A++
Evolve 9.2 30K	567145	neutral white	4000	730	120	1015	114	3330	80	25	A++
Evolve 9.2 40K	567146	neutral white	4000	760	125	1050	118	2190	80	35	A++
Warm white – 2700 K – Drawing B											
Evolve 7.2 27K	567129	warm white	2700	685	112	—	—	5000	80	14	A++
Evolve 7.2 27K	567130	warm white	2700	675	111	—	—	2200	80	25	A++
Evolve 7.2 27K	567131	warm white	2700	700	115	—	—	1500	80	35	A++
Warm white – 3000 K – Drawing B											
Evolve 7.2 30K	567132	warm white	3000	710	116	—	—	5200	80	14	A++
Evolve 7.2 30K	567133	warm white	3000	705	116	—	—	2300	80	25	A++
Evolve 7.2 30K	567134	warm white	3000	725	119	—	—	1550	80	35	A++
Neutral white – 4000 K – Drawing B											
Evolve 7.2 40K	567135	neutral white	4000	740	121	—	—	5400	80	14	A++
Evolve 7.2 40K	567136	neutral white	4000	730	120	—	—	2400	80	25	A++
Evolve 7.2 40K	567137	neutral white	4000	760	125	—	—	1610	80	35	A++

Production tolerance of luminous flux and efficiency: ± 10%

The values contained in this data sheet can change due to technical innovations. Any such changes will be made without separate notification.

Evolve Halo

Dim to warm

Technical notes

Lens: Ø 50 mm
 Heat sink material: aluminium
 Lumen maintenance: L90/B10; 50,000 hrs. 80 °C (350 mA)
 Max. operating temperature at t_p point: 100 °C at 350 mA
 Temperature depends on installation situation and has to be checked by the luminaire manufacturer.
 Colour accuracy initially: 3 SDCM
 Leads: Cu tinned, stranded conductors 0.5 mm², length: 200 mm, with plug
 With integrated cord grip
 Weight: 160 g
 Packaging unit: 28 pcs.

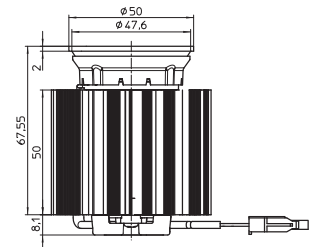
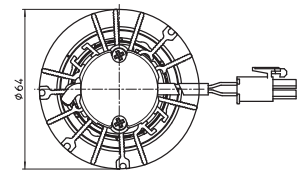

Electrical characteristics

Type	14 mA		350 mA	
	P _{el} [W]	V _f [V]	P _{el} [W]	V _f [V]
Evolve HALO	0.4	26.9	11.3	33.8

Voltage and power tolerance: ± 10%

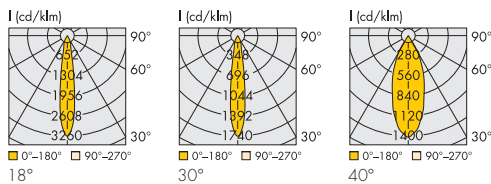

Type	Ref. No.	Colour	Correlated colour temp. K	Typ. luminous flux and colour temperature at				Light intensity at max. current Candela	CRI R _a	Beam angle °	Energy efficiency at max. current
				14 mA		350 mA					
				lm	K	lm	K				
Evolve HALO – Warm white											
Evolve HALO	567187	warm white	3000 → 1800	25	1800	920	3000	3000	95	18	A+
Evolve HALO	567188	warm white	3000 → 1800	25	1800	920	3000	1600	95	30	A+
Evolve HALO	567832	warm white	3000 → 1800	25	1800	920	3000	1300	95	40	A+

Production tolerance of luminous flux: ± 10%

The values contained in this data sheet can change due to technical innovations. Any such changes will be made without separate notification.