

## LED SPOT

### SMARTLINE SMD



## SMARTLINE SMD – RECESSED MOUNTED LED SPOT

As the perfect replacement for traditional halogen spotlights, these LEDSpots with an SMD LED are available with a round or square frame and are ideal for use in furnitures, shelves and false ceilings.

A LEDSpot with rounded front part that clearly sets it apart from any other spotlights.

The elegant, simple design with rounded front part makes it perfect for creating the right lighting atmosphere. This LEDSpot differs clearly from any other spotlights.

### Typical applications

- Furniture lighting
- Residential Lighting
- Retail lighting

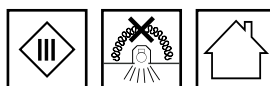

### SmartLine SMD

- **CONSTANT-CURRENT OR VOLTAGE-DRIVEN**
- **DEGREE OF PROTECTION: IP40**
- **FIXATION: SNAP-IN CLIPS OR SPRINGS FOR MANY DIFFERENT APPLICATIONS AND WALL THICKNESSES**
- **5 YEARS GUARANTEE**
- **MADE IN ITALY**



## SmartLine 700 mA

**Complete LEDSpot equipped with optics, heat sink, leads and metal frame**

### Technical notes

Metal frame, round or square

For cut-out: Ø 56 mm

LEDSpot with one LED and with thermoplastic heat sink

Optics beam angle: 40°

Colour accuracy initially: 3 SDCM

CRI R<sub>a</sub>: 80

Leads: Cu tinned, stranded conductors AWG22,  
PVC-insulation, length: 250 mm

Use of external LED constant-current drivers

Snap-in clips or springs for easy installation  
for luminaire sheets (type LCH-002 and -008)  
for ceilings (type LCH-004 and -009)

Degree of protection: IP40

Allowed ambient temperature: 0 to 40 °C

Allowed storage temperature: -30 to 60 °C

Lumen maintenance L70/B50:

50,000 hrs. (t<sub>c</sub>/t<sub>p</sub> = 70 °C)

Max. operating temperature at t<sub>c</sub> point: 85 °C

Weight: 55 g

Packaging unit:

45 pcs. (type LCH-002 and -008)

40 pcs. (type LCH-004 and -009)

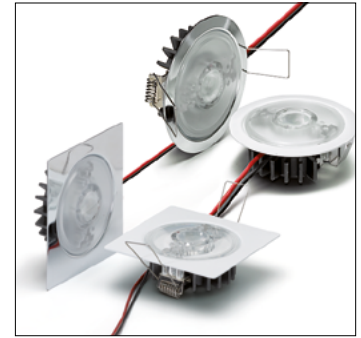

**LCH-002**

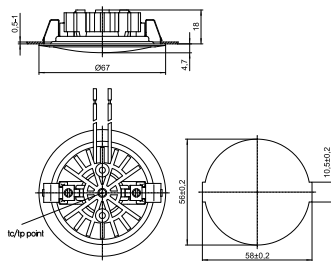

**LCH-004**

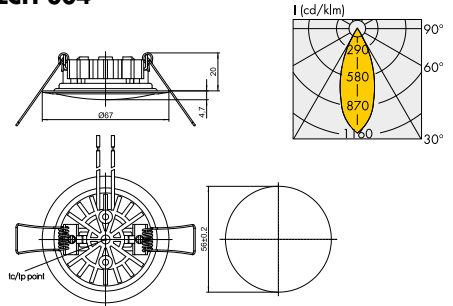

**LCH-008**

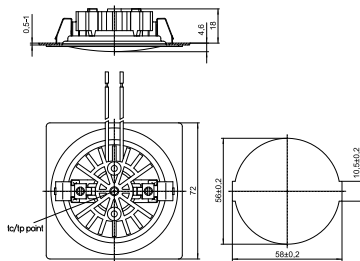

**LCH-009**

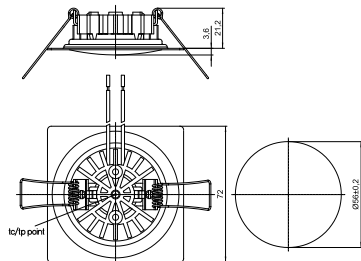

| Type      | Description     | LEDSpot version      |          | Colour        | Correlated colour temperature K | Luminous flux (lm) and typical voltage (U <sub>typ.</sub> ) and power consumption (P <sub>el</sub> )* |                           |                           | Light intensity at max. current Candela | Frame shape |        |
|-----------|-----------------|----------------------|----------|---------------|---------------------------------|---|---------------------------|---------------------------|---|-------------|--------|
|           |                 | for luminaire sheets | ceilings |               |                                 | 350 mA typ.   | 500 mA typ.               | 700 mA typ.               |   | round       | square |
|           |                 |                      |          |               |                                 | P <sub>el</sub> = 0.98 W  | P <sub>el</sub> = 1.45 W  | P <sub>el</sub> = 2.1 W   |   |             |        |
|           |                 |                      |          |               |                                 | U <sub>typ.</sub> = 2.8 V   | U <sub>typ.</sub> = 2.9 V | U <sub>typ.</sub> = 3.0 V |   |             |        |
| All types | Smart 219 3000K | <b>A</b>             | <b>C</b> | warm white    | 3000                            | 130   | 170                       | 220                       | 240                                     | round       | square |
| All types | Smart 219 4500K | <b>B</b>             | <b>D</b> | neutral white | 4500                            | 140   | 190                       | 250                       | 255                                     | round       | square |

Emission data at t<sub>i</sub> = 85 °C | \* Production tolerance of luminous flux, voltage and power consumption: ±7% | Further colour temperatures on request

| Frame colour | For luminaire sheets (LCH-002 and LCH-008) |               |                            |               | For ceilings (LCH-004 and LCH-009) |               |                            |               |
|--------------|--|---------------|----------------------------|---------------|------------------------------------|---------------|----------------------------|---------------|
|              | Ref. No. A (warm white)                    |               | Ref. No. B (neutral white) |               | Ref. No. C (warm white)            |               | Ref. No. D (neutral white) |               |
|              | round                                      | square        | round                      | square        | round                              | square        | round                      | square        |
| silver       | <b>561778</b>                              | <b>561781</b> | <b>561783</b>              | <b>561786</b> | <b>561788</b>                      | <b>561791</b> | <b>561794</b>              | <b>561797</b> |
| silver mat   | <b>561779</b>                              | —             | <b>561809</b>              | —             | <b>561789</b>                      | —             | <b>561795</b>              | —             |
| white        | <b>561780</b>                              | <b>561782</b> | <b>561785</b>              | <b>561787</b> | <b>561790</b>                      | <b>561792</b> | <b>561796</b>              | <b>561798</b> |

Silver brushed or further colours on request

The values contained in this data sheet can change due to technical innovations. Any such changes will be made without separate notification.

# LEDSpot SmartLine SMD – Furniture and Residential Lighting

## LED driver

You will find more information about our LED drivers on our website: [www.vossloh-schwabe.com](http://www.vossloh-schwabe.com)

| Capacity range<br>W | Output current DC<br>mA | Output voltage DC<br>V | Ref. No.      | Version     | Current setting | Dimming | Max. service<br>life time (hrs.) | Dimensions:<br>mm (LxWxH) |
|---------------------|-------------------------|------------------------|---------------|-------------|-----------------|---------|----------------------------------|---------------------------|
| <b>700 mA</b>       |                         |                        |               |             |                 |         |                                  |                           |
| 5.6                 | 700                     | 2.8–8                  | <b>186348</b> | EasyLine    | —               | —       | 50,000                           | 81.6x42.5x23              |
| 17.5                | 700                     | 2–25                   | <b>186681</b> | ComfortLine | —               | —       | 100,000                          | 128x37x28                 |
| <b>350 mA</b>       |                         |                        |               |             |                 |         |                                  |                           |
| 8.75                | 350                     | 2–25                   | <b>186519</b> | ComfortLine | —               | —       | 100,000                          | 65x30.7x21.5              |
| 11                  | 350                     | 2–32                   | <b>186679</b> | ComfortLine | —               | —       | 100,000                          | 128x37x28                 |

Please ensure you choose the correct LED driver for the module in question and that the respective output parameters (current, voltage, wattage) are correct.

## SmartLine 12 V DC

**Complete LEDSpot equipped with optics, heat sink, leads and metal frame**

### Technical notes

CA system control  
 Round frame: metal, silver  
 For cut-out: Ø 56 mm  
 LEDSpot with one LED and with thermoplastic heat sink  
 Optics beam angle: 36°  
 CRI R<sub>a</sub>: 80  
 Leads: Cu tinned, stranded conductors AWG22,  
 PVC-insulation, length: 250 mm  
 Use of external LED constant-voltage converter  
 Snap-in clips for easy installation  
 Degree of protection: IP40  
 Allowed ambient temperature: 0 to 40 °C  
 Allowed storage temperature: -30 to 60 °C  
 Lumen maintenance L70/B50:  
 50,000 hrs. (t<sub>c</sub>/t<sub>p</sub> = 70 °C)  
 Max. operating temperature at t<sub>c</sub> point: 80 °C  
 Weight: 55 g  
 Packaging unit: 45 pcs.

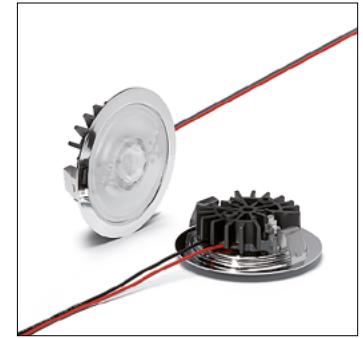

**LCH-051**

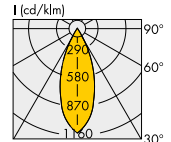
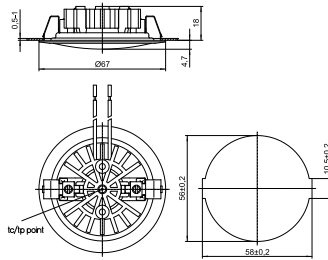

| Type | Description | Ref. No. | Colour | Correlated colour temperature K | Max. power consumption W | Typ. luminous flux* lm | Typ. CRI R <sub>a</sub> | Beam angle ° | Light intensity Candela |
|------|-------------|----------|--------|---------------------------------|--------------------------|------------------------|-------------------------|--------------|-------------------------|
|------|-------------|----------|--------|---------------------------------|--------------------------|------------------------|-------------------------|--------------|-------------------------|

### SmartLine 12 V DC

|        |               |               |               |      |   |     |    |    |     |
|--------|---------------|---------------|---------------|------|---|-----|----|----|-----|
| LCH051 | Smart Wi 12 V | <b>569249</b> | warm white    | 3000 | 2 | 155 | 80 | 36 | 280 |
| LCH051 | Smart Wi 12 V | <b>568262</b> | neutral white | 4000 | 2 | 160 | 80 | 36 | 280 |

Emission data at t<sub>i</sub> = 85 °C | \* Measurement tolerance of luminous flux, voltage, power consumption: ± 7% | Further colour temperatures and frame colours on request

### LED converters

You will find more information about our LED converter on our website: [www.vossloh-schwabe.com](http://www.vossloh-schwabe.com)

| Capacity range W | Mains voltage 50–60 Hz V ± 10 % | Output current A | Ref. No. | Version | Max. service life time hrs. | Service life time at °C | Connection | Dimensions LxWxH mm |
|------------------|---------------------------------|------------------|----------|---------|-----------------------------|-------------------------|------------|---------------------|
|------------------|---------------------------------|------------------|----------|---------|-----------------------------|-------------------------|------------|---------------------|

### 12 V

|     |         |        |               |             |         |         |                    |              |
|-----|---------|--------|---------------|-------------|---------|---------|--------------------|--------------|
| 6   | 220–240 | 0–0.5  | <b>186412</b> | EasyLine    | 50,000  | 55      | Preassembled leads | 81.6x42.5x23 |
| 12  | 220–240 | 0–1    | <b>186204</b> | ComfortLine | 100,000 | 65      | Screw terminals    | 103.5x36x22  |
| 20  | 220–240 | 0–1.68 | <b>186620</b> | EasyLine    | 50,000  | 65      | Screw terminals    | 123x45x19    |
| 60  | 220–240 | 0–5    | <b>186621</b> | EasyLine    | 50,000  | 70 / 80 | Screw terminals    | 180x52x30    |
| 75  | 220–240 | 0–6.25 | <b>186622</b> | EasyLine    | 50,000  | 75      | Screw terminals    | 180x52x30    |
| 100 | 220–240 | 0–8.4  | <b>186623</b> | EasyLine    | 50,000  | 70 / 80 | Screw terminals    | 300x40x30    |

Please ensure you choose the correct LED driver for the module in question and that the respective output parameters (current, voltage, wattage) are correct.

## Surface Kit with Mounted LEDSpot

Metal frame to use LEDSpot IPLine, SmartLine, StartLine or Flatline as surface mounting spots  
 Two single pole terminals for electrical connection inside the kit (frame + spot)  
 Fixation by self tapping screws  
 Packaging unit: 90 pcs.

**Ref. No.: 554845** Frame colour: white

**Ref. No.: 554843** Frame colour: silver

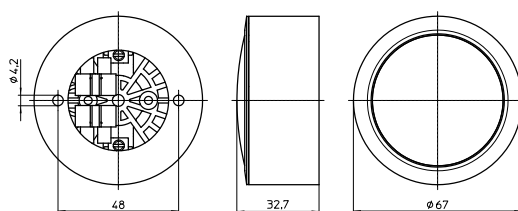

## SmartLine SMD – Installation Instruction

### General safety information

- VS product may only be installed and commissioned by authorised and fully qualified staff.
- These instructions must be carefully read before installing and commissioning the system, as this is the only way to ensure safe and correct handling.
- An external driver for max. 700 mA or an external converter 12 V DC is required.
- Before any work is carried out on the equipment, it must be disconnected from the mains.
- All valid safety and accident-prevention regulations must be observed.
- The products should never be inexpertly opened. Repairs may only be undertaken by the manufacturer.
- Dimming: The dimming characteristics of the installed driver have to be observed.
- The photo biological safety of the LED modules is classified into risk groups in accordance with EN 62471: 2008 and IEC TR 62778: risk group 1.

See drawing and cut out for each product on previous pages

### Built-in

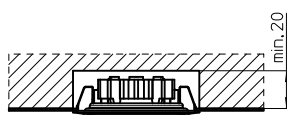

### Correct position

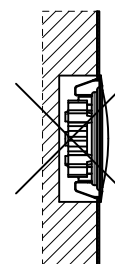
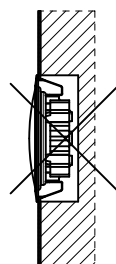
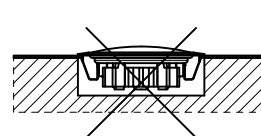
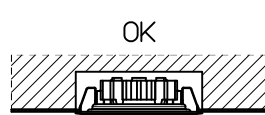

The values contained in this data sheet can change due to technical innovations. Any such changes will be made without separate notification.

## All VS LED Spots at a glance

### Tiny

LEDSpot with optics, leads and metal frame  
For cut-out: Ø 26 mm  
Beam angle: 36°  
Lumen output: max. 140 lm  
Versions: CC, CV, Kit



### IPLine

LEDSpot IP54 with optics, heat sink, leads and metal frame  
For cut-out: Ø 56 mm  
Beam angle: 40°  
Lumen output: max. 330 lm  
Versions: CC



### FlatLine

LEDSpot with optics, leads and metal frame  
For cut-out: Ø 56 mm  
Beam angle: 60°, 70°  
Lumen output: max. 270 lm  
Versions: CC, CV, TW, Kit



### SoftLine

LEDSpot with heat sink, leads and metal frame  
For cut-out: Ø 56 mm  
Beam angle: 90°  
Lumen output: max. 225 lm  
Versions: CV



### SmartLine COB

LEDSpot with optics, heat sink, leads and metal frame  
For cut-out: Ø 56 mm  
Beam angle: 40°  
Lumen output: max. 330 lm  
Versions: CC



### Revo

LEDSpot with optics and frame  
For cut-out: 67.5x25x5 mm  
Beam angle: 60°, 70°  
Lumen output: max. 255 lm  
Versions: CC, CV, TW



### SmartLine SMD

LEDSpot with optics, heat sink, leads and metal frame  
For cut-out: Ø 56 mm  
Beam angle: 36°, 40°  
Lumen output: max. 250 lm  
Versions: CC, CV

